

Riser Clamp



• For Schedule 40 iron pipe only - Not for soil pipe

PART NO.	SIZE	OVERALL WIDTH	CTN QTY
H70050	1/2"	9-3/8"	25
H70075	3/4"	9-3/8"	25
H70100	1"	9-3/8"	25
H70125	1-1/4"	10"	25
H70150	1-1/2"	10-3/8"	25
H70200	2"	10-7/8"	25
H70250	2-1/2"	11-1/4"	25
H70300	3"	11-3/4"	10
H70350	3-1/2"	13-1/4"	10
H70400	4"	13-1/2"	10

Hinged Split Ring



Zinc Plated for Iron Pipe

PART NO.	SIZE	ROD SIZE	CTN QTY
H72375	3/8"	3/8"	25
H72050	1/2"	3/8"	25
H72075	3/4"	3/8"	25
H72100	1"	3/8"	25
H72125	1-1/4"	3/8"	25
H72150	1-1/2"	3/8"	25
H72200	2"	3/8"	20
H72250	2-1/2"	1/2"	20
H72300	3"	1/2"	10
H72400	4"	1/2"	10

Copper Plated for Copper Tube

PART NO.	SIZE	ROD SIZE	CTN QTY
H73375	3/8"	3/8"	25
H73050	1/2"	3/8"	25
H73075	3/4"	3/8"	25
H73100	1"	3/8"	25
H73125	1-1/4"	3/8"	25
H73150	1-1/2"	3/8"	25
H73200	2"	3/8"	10

Ceiling Flange

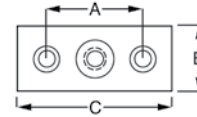

DIMENSIONS		
A	B	C
2"	1-3/8"	2-3/4"

PART NO.	SIZE	CTN QTY
H80375	3/8" plain finish (black)	25
H80050	1/2" plain finish (black)	25
H81375	3/8" zinc finish (galvanized)	25
H81050	1/2" zinc finish (galvanized)	25
H82375	3/8" copper finish	25
H82050	1/2" copper finish	25

Threaded Steel Rod



• Priced per rod
• CARTON QUANTITIES ONLY

PART NO.	DESCRIPTION	CTN QTY
T38006	3/8" x 6' plain finish (black)	25
T38010	3/8" x 10' plain finish (black)	25
T12006	1/2" x 6' plain finish (black)	12
T12010	1/2" x 10' plain finish (black)	12
T38106	3/8" x 6' zinc finish (galvanized)	25
T38110	3/8" x 10' zinc finish (galvanized)	25
T12106	1/2" x 6' zinc finish (galvanized)	12
T12110	1/2" x 10' zinc finish (galvanized)	12

Drop-In Concrete Anchor



• Priced per rod
• CARTON QUANTITIES ONLY

PART NO.	DESCRIPTION	CTN/MSTR
T38038	3/8" drop-in anchor	100/900
T12050	1/2" drop-in anchor	50/500

Rod Coupling Nut



• Hex, zinc plated, carbon steel

PART NO.	DESCRIPTION	CTN/MSTR
R60001	1/4" x 7/8" rod coupling nut	50/1000
R60002	3/8" x 1-3/4" rod coupling nut	50/1000
R60003	1/2" x 1-3/4" rod coupling nut	50/1000
R60004	5/8" x 2-1/8" rod coupling nut	50/200